



KANGAROO™
sewing furniture

ASSEMBLY INSTRUCTIONS

Bernina Embroidery Arm Storage Drawer

for Sydney Cabinet

ITEM NO.:	KB4705	Teak
	KB4707	Gray
	KB4711	Ash White

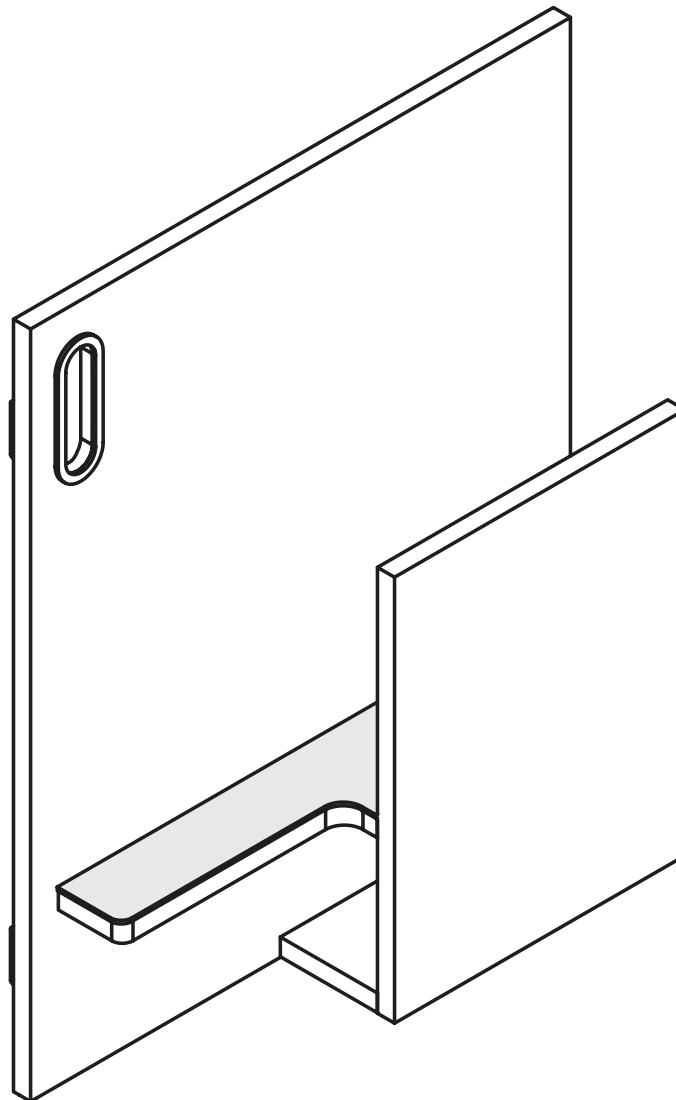

SEW IN COMFORT. SEW LONGER.™

General Assembly Guidelines

1. Read the instructions carefully before beginning the assembly process to ensure proper assembly of this product. Please open and inspect the contents of box(es) to see that all parts and hardware are included.

2. Tools Required



Phillips Screwdriver +



Hammer

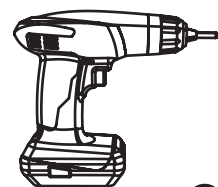

Electric Screwdriver +
Torque set to 3-5

3. Understanding How the Cam Fastener Works

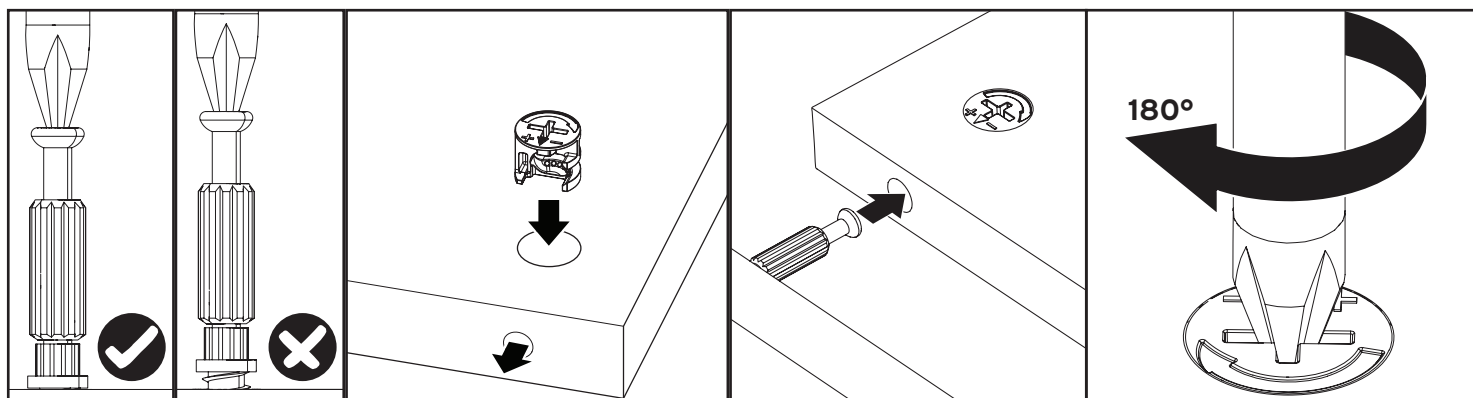

Screw cam bolts flush as illustrated.

Press cam into hole until flush with surface. The arrow direction must be in the direction of the hole.

Insert bolt through pre-drilled hole in edge of panel.

Turn clockwise to lock cam with bolt.

Tip: place a small bit of WD-40 or similar lubricant into the pre-installed cam bolt holes to help the cam bolts screw in better.

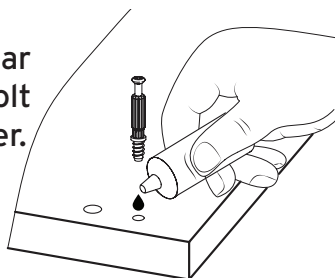

4. **Glue** provided is to secure wood dowels in place and is optional. If glue is used during assembly, locate the appropriate hole for the dowel, place a small amount of glue in the hole and insert the dowel. Wipe away excess glue immediately. It is not necessary to glue the other end of the dowel when attaching to other parts.

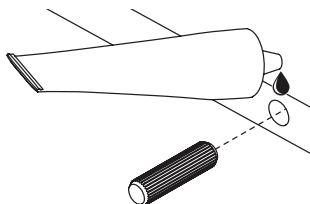

Use and Care Your cabinet normally requires a minimum amount of maintenance; however, the following points are worth noting:

Cleaning - To remove marks and enhance the surface, wipe with a gentle all-purpose cleanser. **DO NOT** use ammonia-based, harsh chemicals or abrasive cleaning agents. Wipe dry immediately.

Electrical and Hydraulic Lifts - Require annual lubrication with WD-40 or similar lubricant.

Parts List

ITEM	DESCRIPTION	QTY.	BOX
01	Large vertical panel	1	1 of 1
02	Small vertical panel	1	1 of 1
F1	Support Ledge	1	1 of 1
F2	Drawer Bottom	1	1 of 1
	EVA Pad for F1 Panel (not pictured)	1	1 of 1

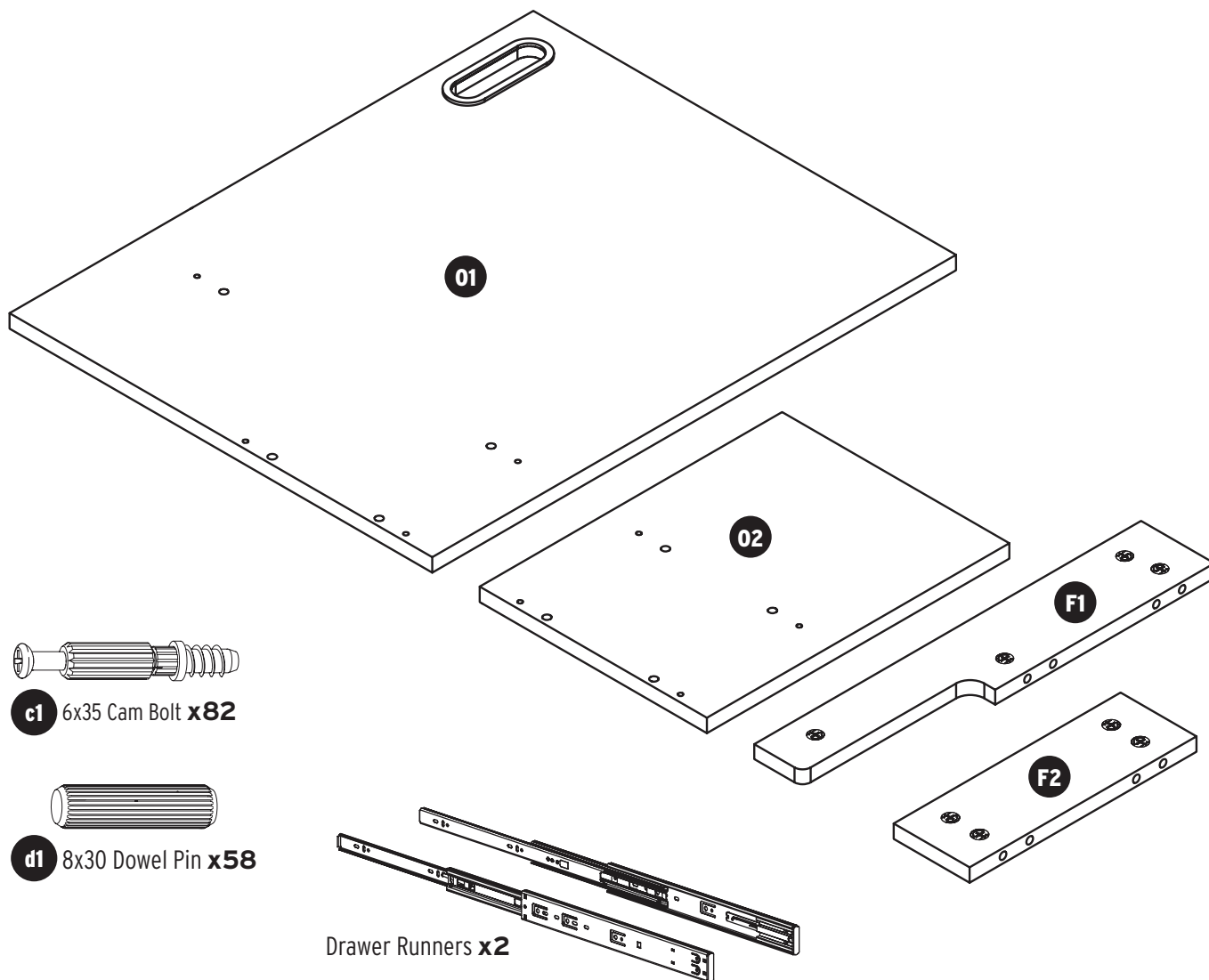

Preparing Panels for Assembly

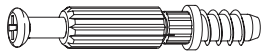

c1 6x35 Cam Bolt **x8**

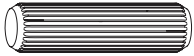

d1 8x30 Dowel Pin **x8**

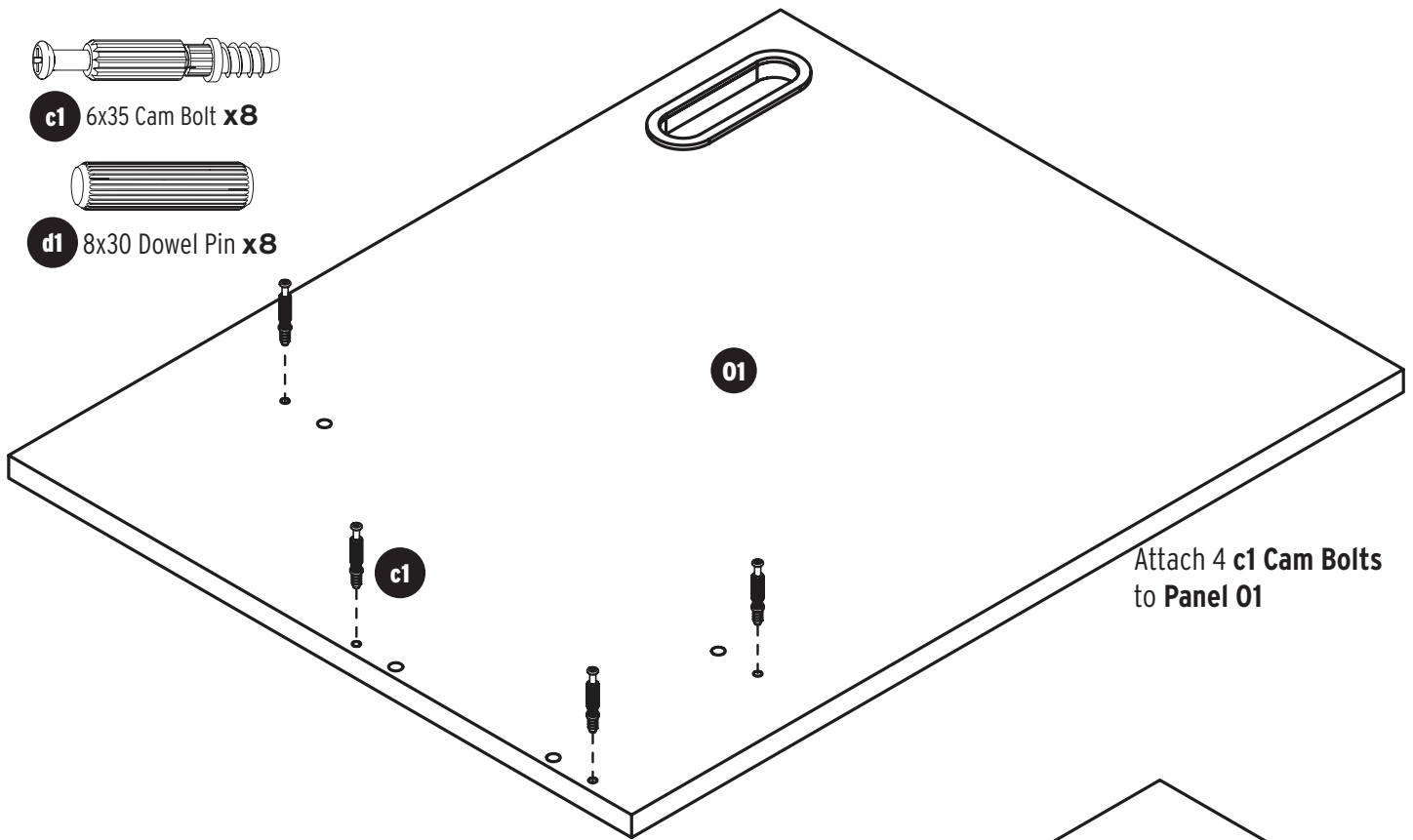

Attach 4 **c1** Cam Bolts
to **Panel 01**

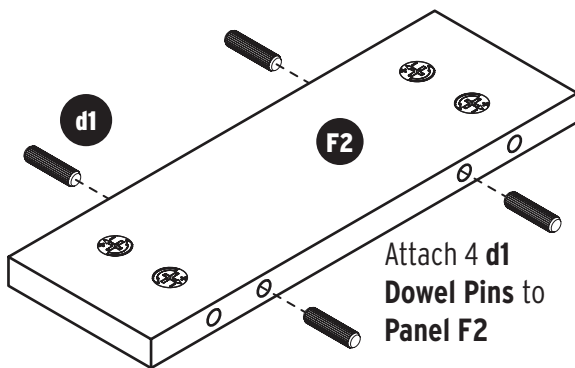

Attach 4 **d1**
Dowel Pins to
Panel F2

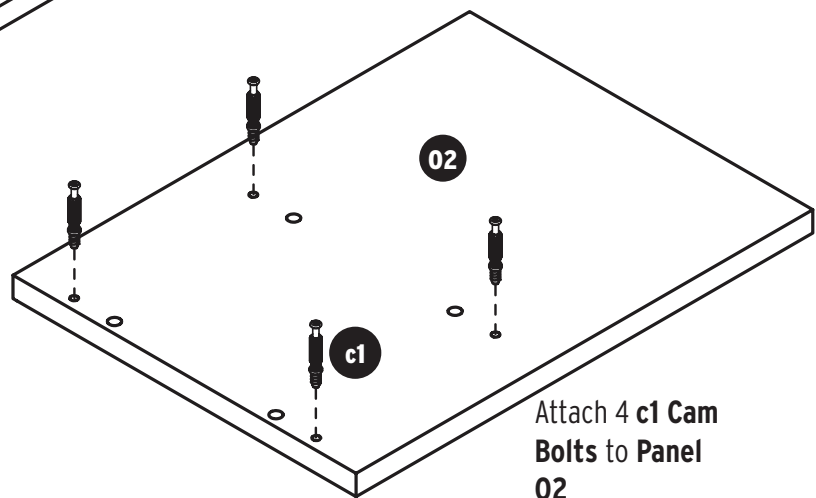

Attach 4 **c1** Cam
Bolts to **Panel**
02

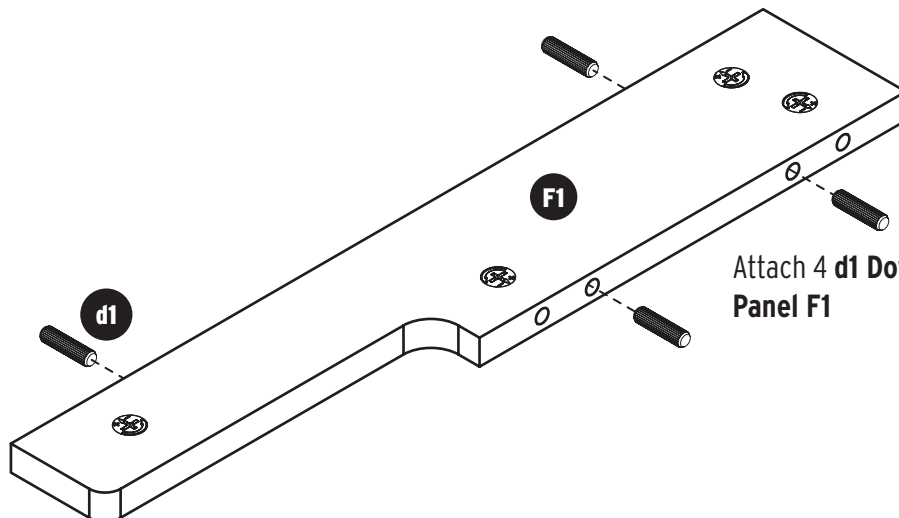

Attach 4 **d1** Dowel Pins to
Panel F1

Assembling the Drawer

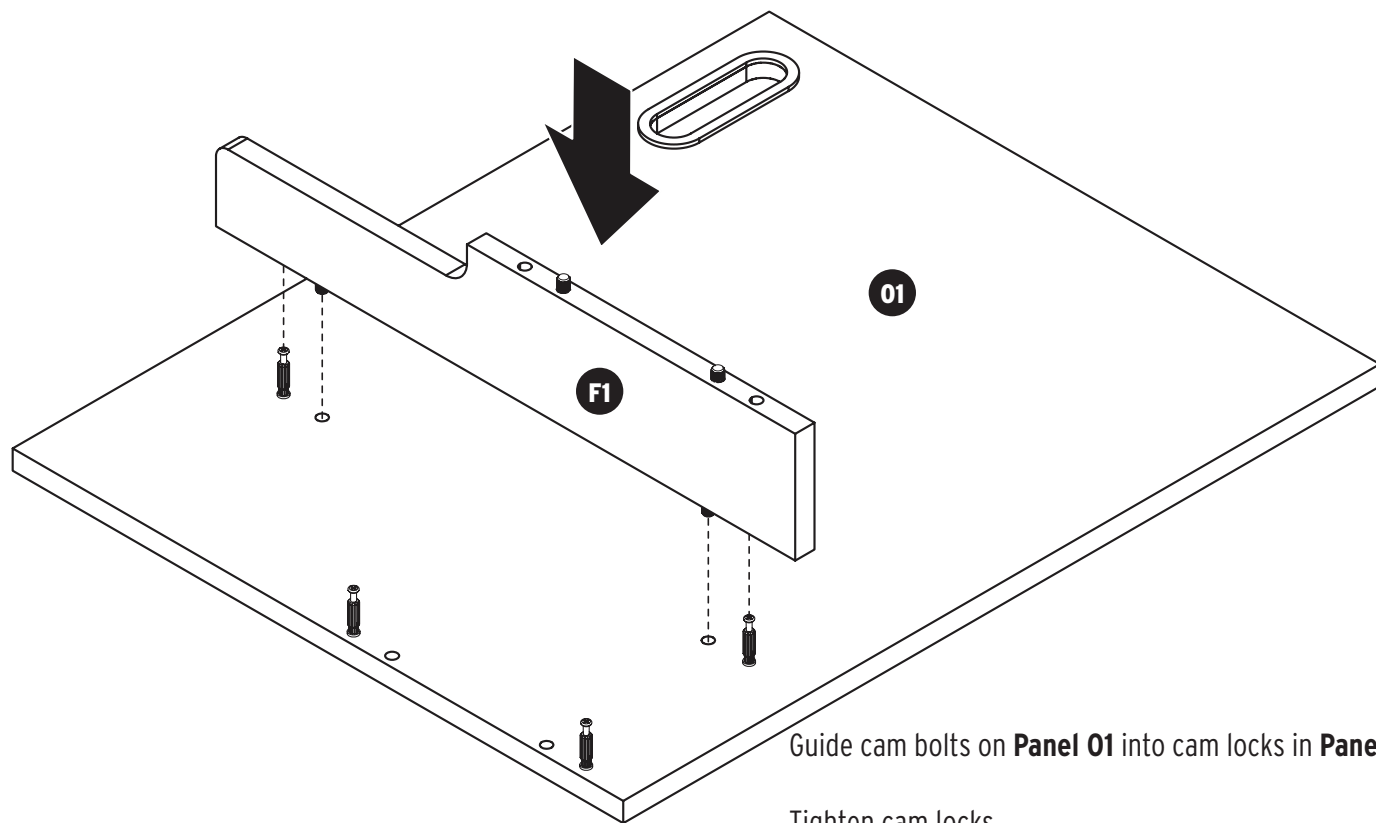

Guide cam bolts on **Panel 01** into cam locks in **Panel F1**.

Tighten cam locks.

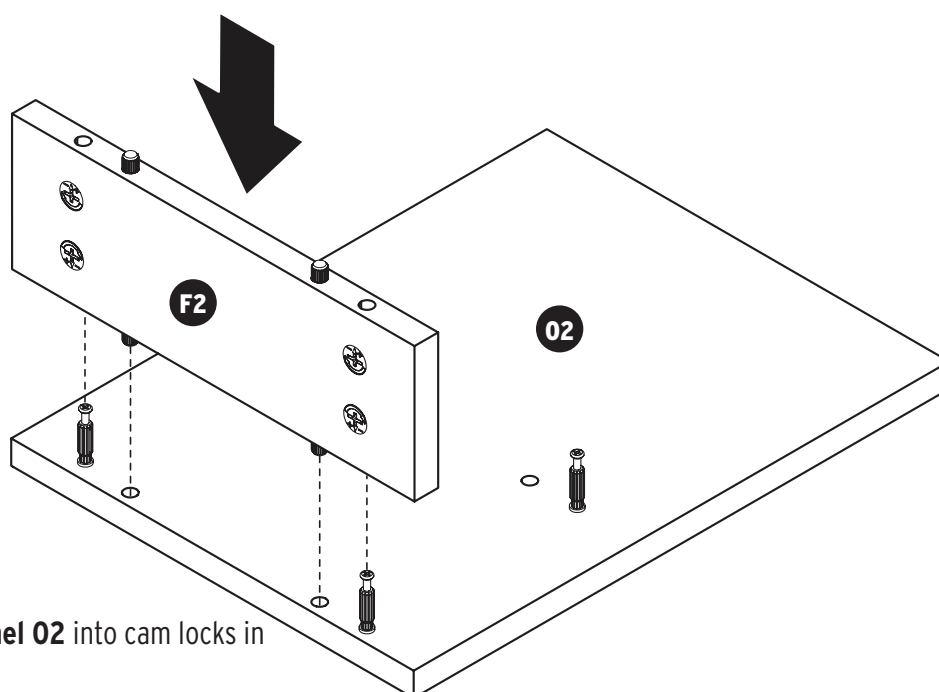

Guide cam bolts on **Panel 02** into cam locks in **Panel F2**.

Tighten cam locks.

Assembling the Drawer

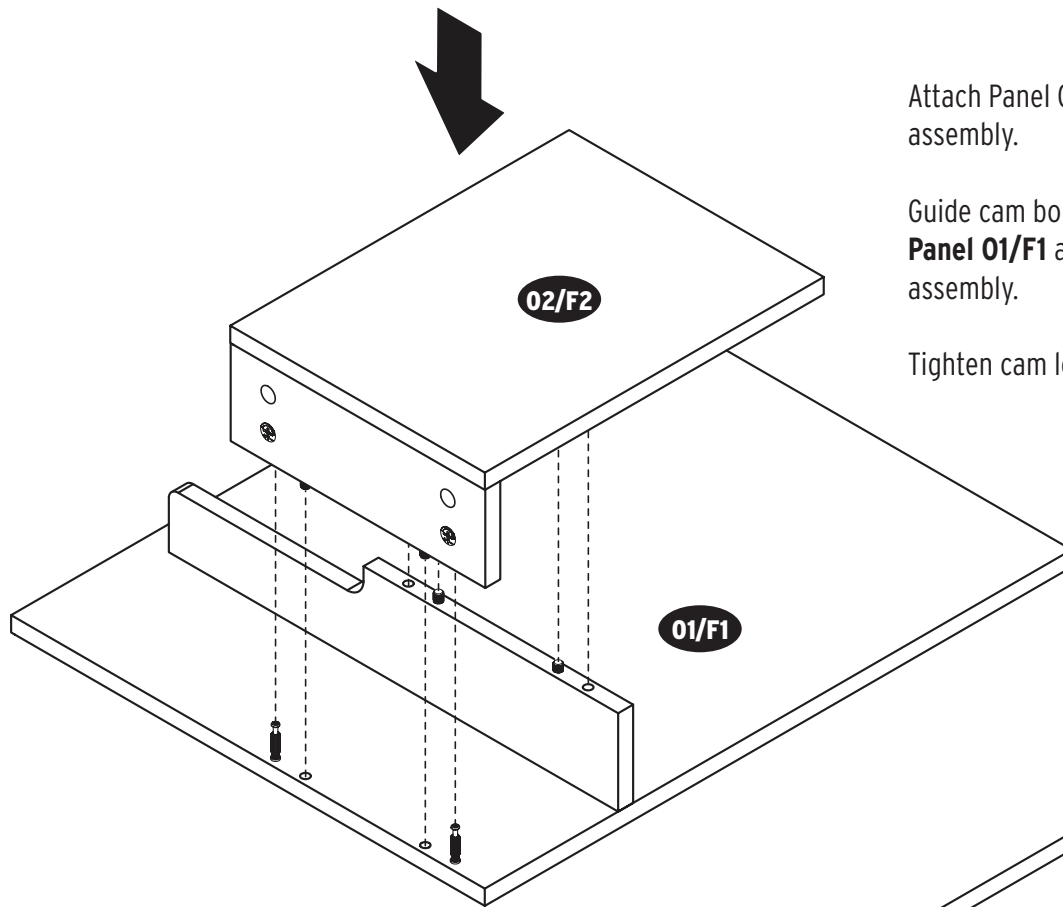

Attach Panel 02/F2 assembly to Panel 01/F1 assembly.

Guide cam bolts into cam locks to attach **Panel 01/F1** assembly to **Panel 02/F2** assembly.

Tighten cam locks.

Carefully adhere **EVA Foam Sheet** to Panel F1 as shown below.

BE CAREFUL! The adhesive is very strong and the EVA Foam Sheet is not easily repositioned.

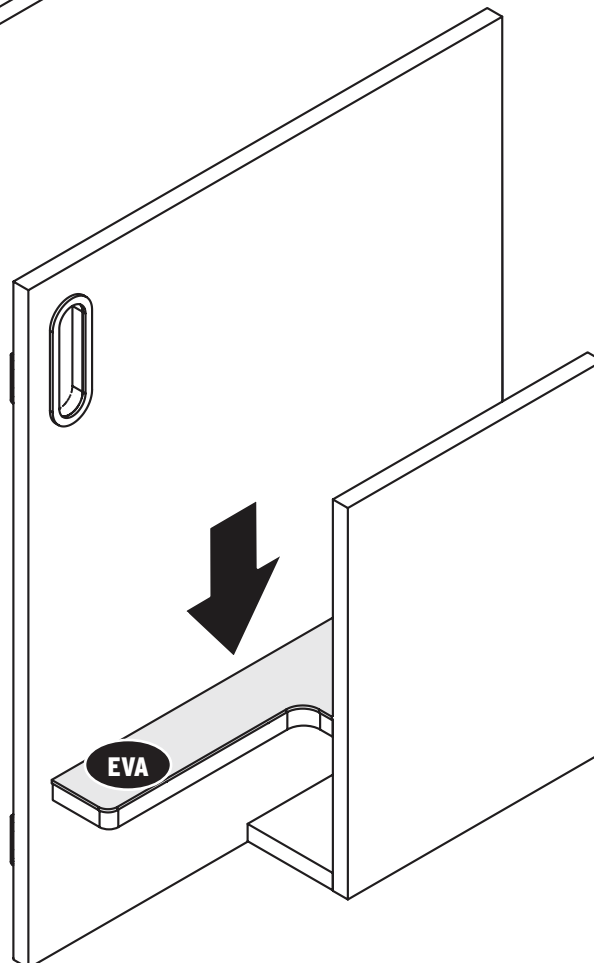

Assembling the Drawer

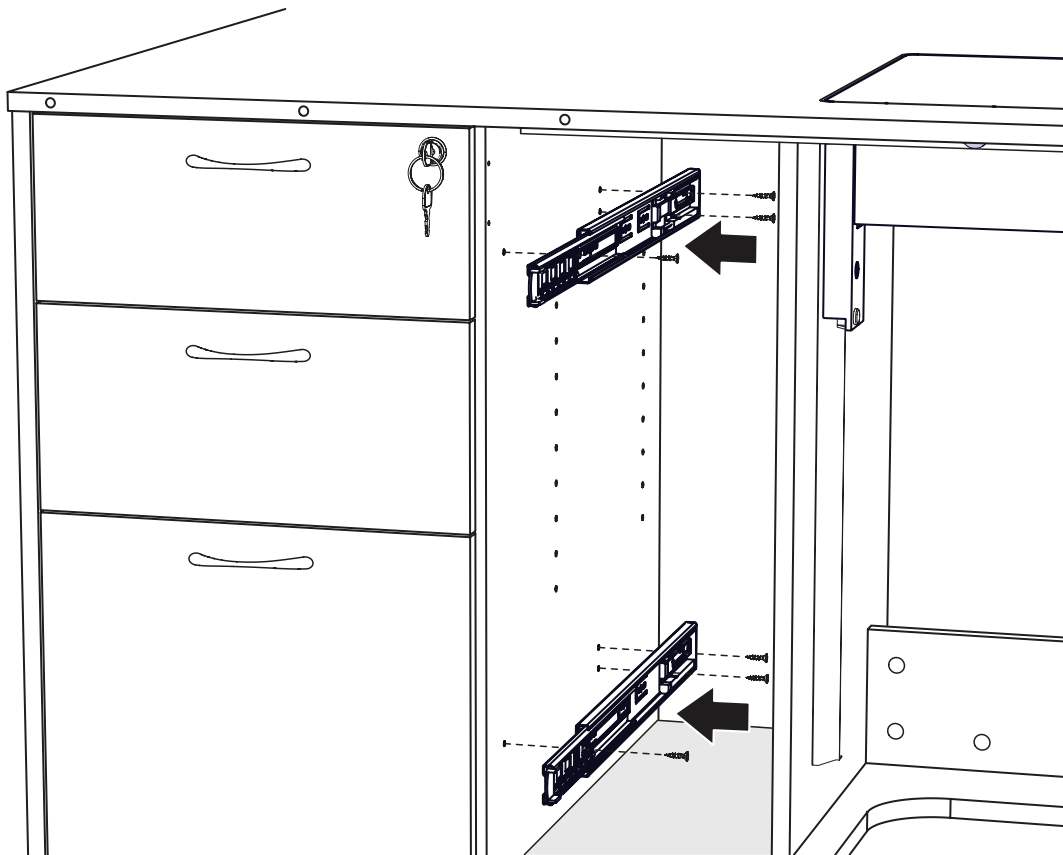

Line up the pre-drilled holes in the cabinet with the holes in the drawer runner and attach with provided screws.

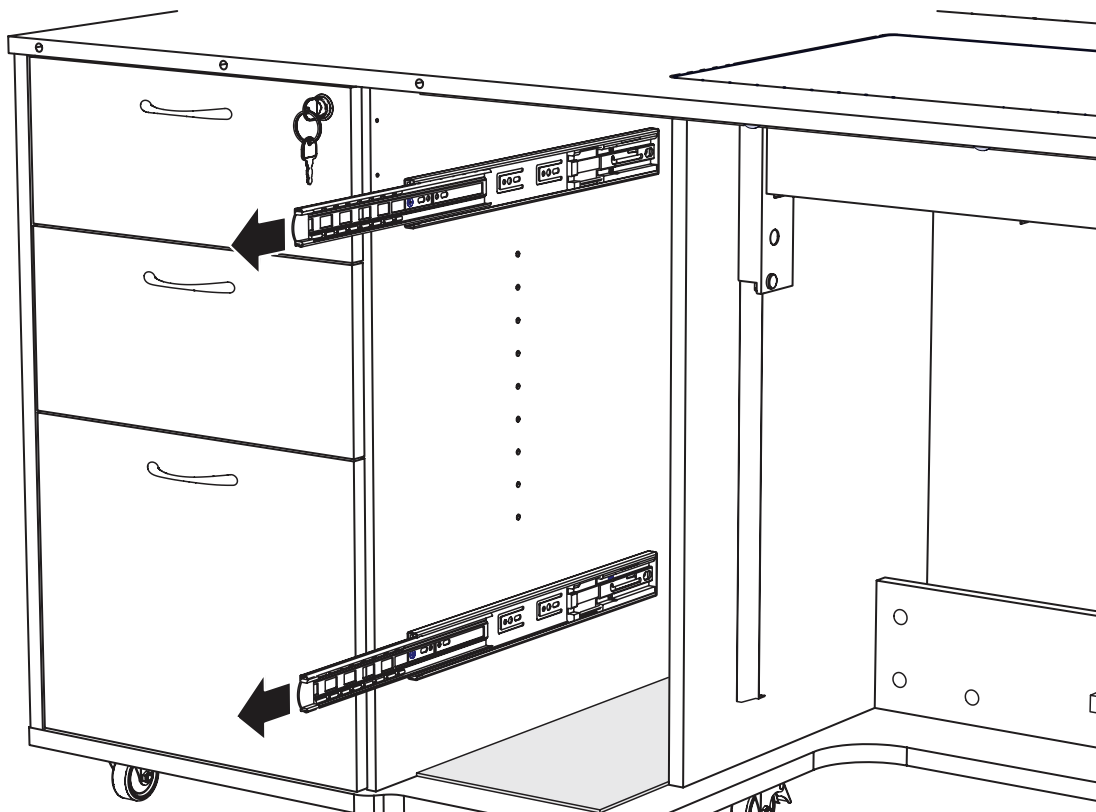

Slide the drawer sliders completely forward, making sure that all silver ball bearings are pulled to the front.

Assembling the Drawer

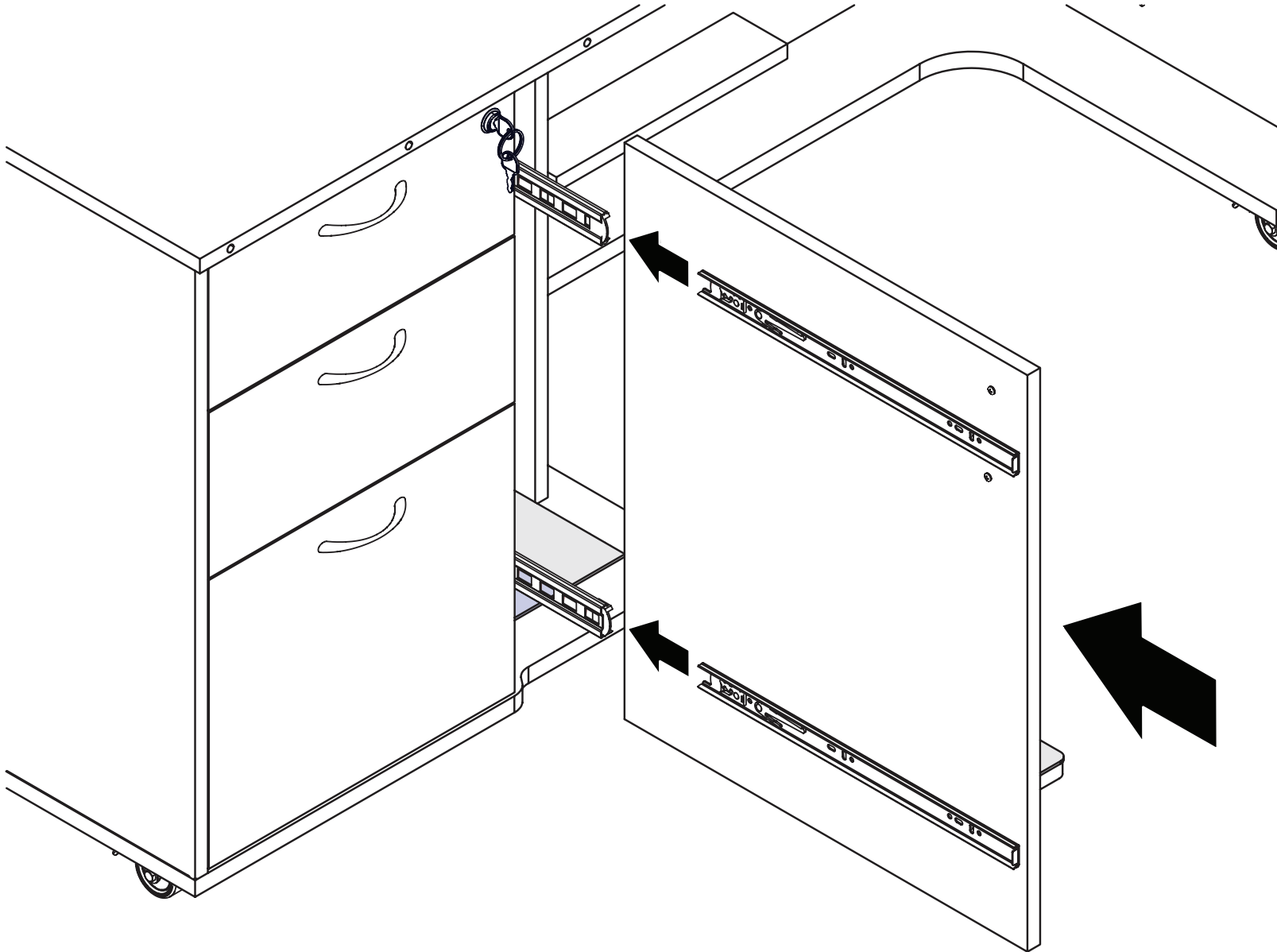

Carefully slide the drawer runners on the back of the drawer into the runners installed on the cabinet. You may need a second person to help you hold the drawer steady, but it is not required.

Gently open and close the drawer a few times to be sure the soft close mechanism has engaged.

For further help, call Customer Service at 1-800-533-7347, ext. 1, or visit www.arrowsewing.com/assembly and scroll down for helpful videos.

Bernina Embroidery Arm Storage Drawer

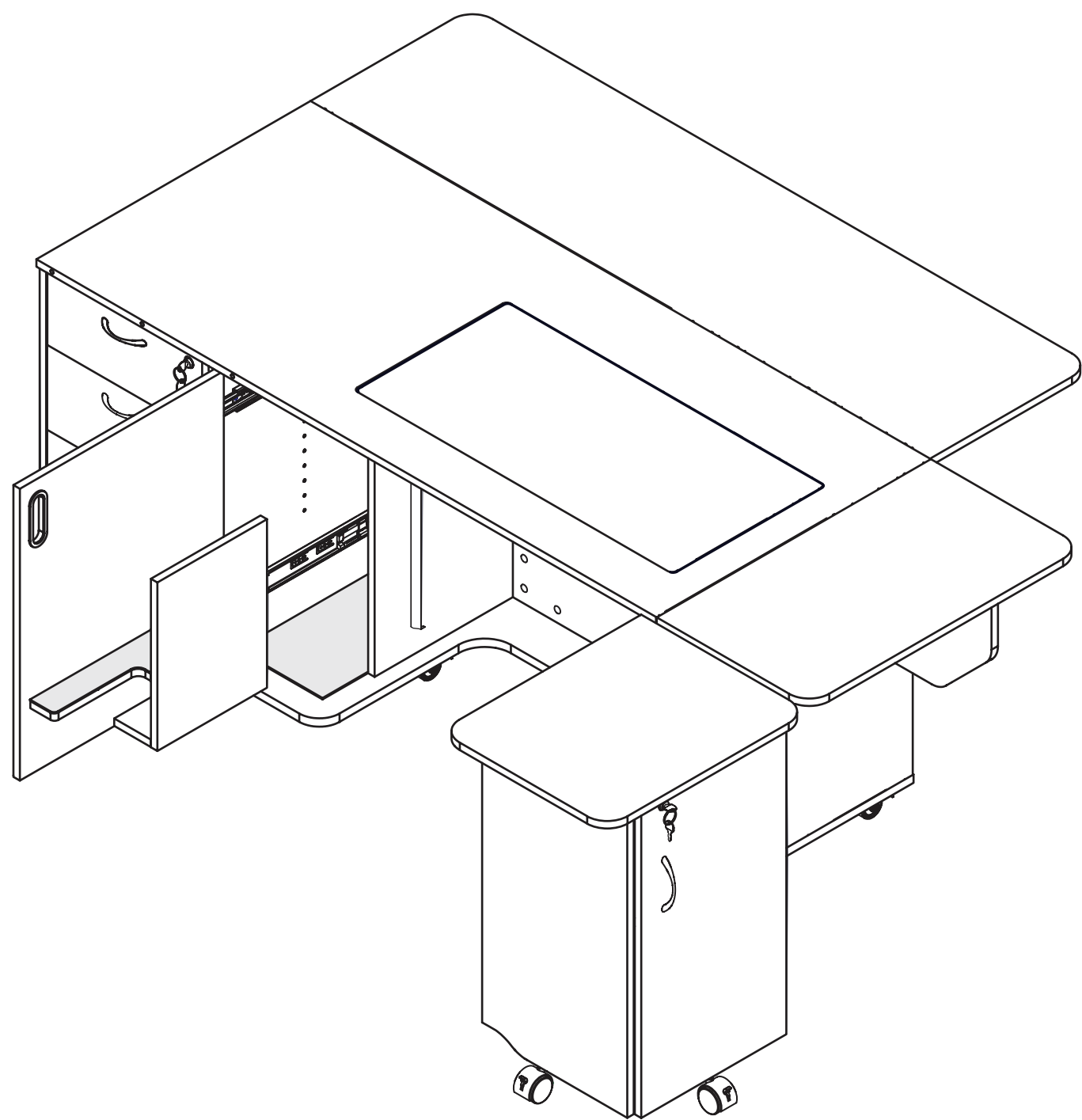



KANGAROO™
sewing furniture

LIMITED LIFETIME WARRANTY

Kangaroo™ Sewing Furniture Limited Lifetime Warranty

WHAT THIS WARRANTY COVERS: Arrow Companies, LLC "Arrow" provides a Limited Lifetime Warranty "Warranty" to the original purchaser of this product against defects in materials or workmanship of furniture components. As used in this Warranty, "defect" means imperfections in components which substantially impair the utility of the product. This Warranty gives you specific legal rights, and you may also have other rights which vary from state to state. Electrical and mechanical components of furniture are warranted for 5 years.

HOW TO GET SERVICE: Simply contact Arrow at 1-800-533-7347 or CS@ArrowSewing.com. When you request Warranty service, you must also present proof of purchase documentation, which includes the date of purchase (detailed receipt), and photos of the product. Arrow will replace any defective part (at its sole option), excluding labor. Replacement parts will be warranted for only the remaining period of the original Warranty.

Replacement parts will be shipped freight prepaid on any initial Warranty claim during first year of Warranty only. Warranty applies only to defects confirmed by Arrow and will be replaced or repaired at Arrow's option. In the event parts are no longer available for a Warranty claim, customer may receive a brand new cabinet at a price equal to 60% off the MSRP of a current comparable model.

WHAT'S NOT COVERED: There is no Warranty coverage for defects or conditions that result from the following: Failure to follow product assembly instructions, information or warnings; misuse or abuse; intentional damage; fire, flood, alteration or modification of the product; use of the product in a manner inconsistent with its intended use; any condition resulting from incorrect or inadequate maintenance, cleaning, care or neglect; cuts or scratches; caster damage as a result of moving furniture fully loaded or with locked casters; damage resulting from electrical surge or lightning; or use in commercial or education environments. Arrow Sewing Furniture is designed for residential use only.

ARROW SHALL HAVE NO LIABILITY for ANY INCIDENTAL OR CONSEQUENTIAL DAMAGES OF ANY KIND and all such damages are EXCLUDED FROM THIS Warranty, such as loss of use, disassembly, transportation, labor, or damage to property on or near the product. Some states do not allow the exclusion or limitation of incidental or consequential damages, so the above limitation or exclusion may not apply to you. The Warranty cannot be transferred to subsequent owners or users of the product, and it shall be immediately void in the event the product is resold, transferred, leased or rented to any third party or person other than the original purchaser.

ADDITIONAL LIMITATIONS: THERE ARE NO OTHER WARRANTIES APPLICABLE TO THIS PRODUCT. Under the laws of certain states, there may be no implied warranties from Arrow and all implied warranties, INCLUDING ANY IMPLIED Warranty OF MERCHANTABILITY OR FITNESS FOR A PARTICULAR PURPOSE are disclaimed where allowed by law. TO THE EXTENT ANY IMPLIED WARRANTIES ARE APPLICABLE, ANY IMPLIED WARRANTIES, INCLUDING ANY IMPLIED Warranty OF MERCHANTABILITY OR FITNESS FOR A PARTICULAR PURPOSE, ARE LIMITED IN DURATION TO THE DURATION OF THIS EXPRESS Warranty or the minimum period allowed by law, whichever is shorter. Some states do not allow limitations on how long an implied Warranty lasts, so the above limitation may not apply to you. This limited Warranty gives you specific legal rights. This limited Warranty does not, in any way, affect the rights given to you by law.

REGISTER YOUR PRODUCT: Original purchaser should register the purchase online at www.ArrowSewing.com/Warranty.

SEW IN COMFORT. SEW LONGER.™



KANGAROO™

sewing furniture

Accessories to Complete Your Sewing Studio

Custom Insert

Enhance your sewing experience with a custom acrylic sewing insert! Custom acrylic sewing inserts are designed to fill the gap between your sewing machine and sewing cabinet's lift opening to create a flush, ergonomic surface for flat bed sewing. To ensure a perfect fit, custom acrylic sewing inserts are built specifically for your sewing machine and sewing cabinet combination. Say hello to happy wrists, straighter stitches, and an elevated sewing experience!

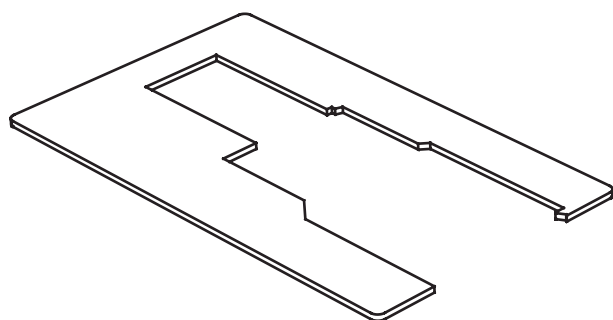

Insert

Arrow Sewing Chairs

Arrow's #1 Rated Height Adjustable Sewing Chair is a must have accessory for your dream sewing room! Cute, comfortable and convenient - our lovable sewing chairs feature vibrant sewing themed patterns, 360 swivel access and lumbar support for long hours at your workstation. Don't look now, but under every seat cushion is a hidden storage compartment to store your notions and patterns! Available in 10 colors to perfectly match your sewing sanctuary!

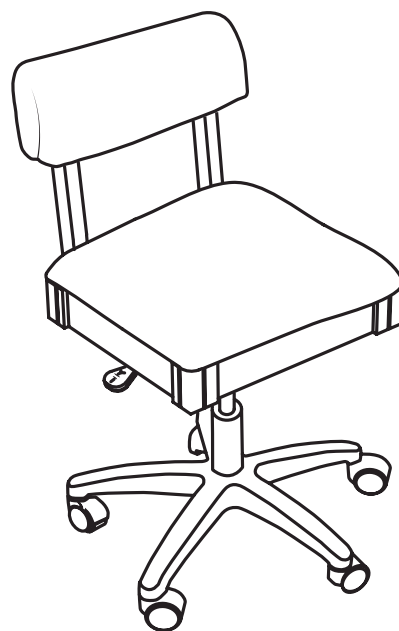

Height Adjustable Sewing Chair

P.O. Box 410 Elkhorn, WI 53121
1-800-533-7347 Ext. 1
CS@ArrowSewing.com
www.ArrowSewing.com

8-23

SEW IN COMFORT. SEW LONGER.™